

## STRAIGHT; SPIN COUPLING

Connector Group J

D38999 Series I & II; MIL-DTL-26482 Series II; AS50151

M85049	/60-2G	W	10
SERIES	SLASH #	FINISH	DASH #
	/60-2G: Straight	A: Anodized Black N: Electroless Nickel W: Cadmium Olive Drab Z: Black Zinc Nickel	TABLE A

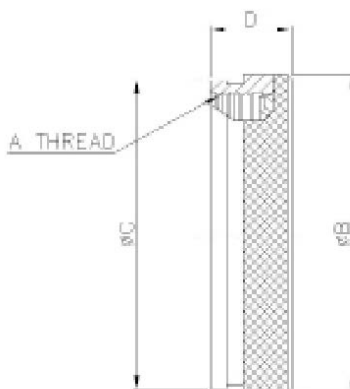

TABLE A								
DASH #	Connector Shell Size	A Ø	B Ø Max.		C Ø Max.		D Max.	
			inch	mm	inch	mm	inch	mm
8	8	0.500-20 UNF	0.688	17.48	0.657	16.69	0.540	13.7
10	10	0.625-24 UNEF	0.803	20.40	0.774	19.66	0.540	13.7
12	7/12	0.750-20 UNEF	0.938	23.83	0.898	22.81	0.540	13.7
14	12/14	0.875-20 UNEF	1.063	27.00	1.024	26.01	0.540	13.7
16	19/16	1.000-20 UNEF	1.238	31.45	1.152	29.26	0.540	13.7
18	27/18	1.0625-18 UNEF	1.310	33.27	1.243	31.57	0.540	13.7
20	37/20	1.1875-18 UNEF	1.436	36.47	1.370	34.80	0.540	13.7
22	22	1.3125-18 UNEF	1.560	39.62	1.443	36.65	0.540	13.7
24	24	1.4375-18 UNEF	1.686	42.82	1.618	41.10	0.540	13.7
28	28	1.750-18 UNS	2.062	52.37	1.969	50.01	0.702	17.8
32	32	2.000-18 UNS	2.312	58.72	2.219	56.36	0.702	17.8
36	36	2.250-16 UN	2.562	65.07	2.469	62.71	0.702	17.8
40	40	2.500-16 UN	2.812	71.42	2.719	69.06	0.702	17.8
44	44	2.750-16 UN	3.062	77.77	2.969	75.41	0.702	17.8
48	48	3.000-16 UN	3.312	84.12	3.219	81.76	0.702	17.8