

SJS862400

| REV | ECN | APP'D |
|-----|-----|-------|
| 1 | | |

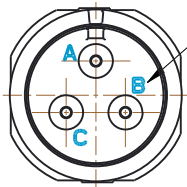

GROMMET MARKING
.040 HIGH CHARACTERS
COLOR: CONTRASTING

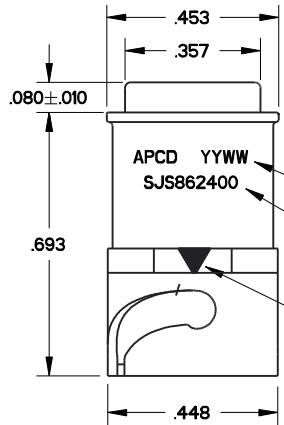

APCD YYWW
SJS862400

DATE CODE

PATE MARKING
TEST HEIGHT: .030
COLOR: BLACK

BLACK MARKING
TWO SIDES

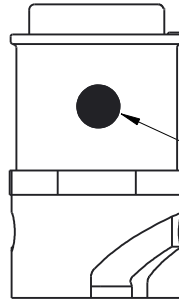

BLACK DOT

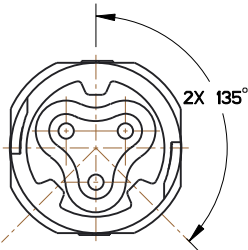
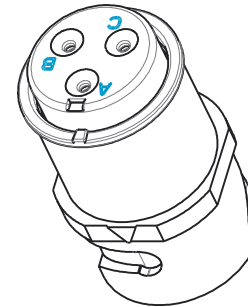

SJS862400

SJS862400

- NOTES:
1. MATERIALS:
HOUSING: PA6/6, COLOR: WHITE
CONTACT RETAINER: STAINLESS STEEL
GROMMET: SILICONE RUBBER PER A-A-59588
2. MATING CONTACTS: SEE TABLE 1
3. PART MATES WITH SJS862300/301
4. WEIGHT: 1.8 GRAMS
5. SUPPLIED WITH DUST CAP.

| APCD P/N | CONTACTS SUPPLIED | HOUSING COLOR | PART MARKING |
|-----------|-------------------|---------------|--------------|
| SJS862400 | (3) M39029/58-363 | WHITE | SJS862400 |
| SJS862401 | NONE | | |

| | | | | | | | |
|--|--|----------------|---------------------------------------|-----------|--|-------------------------|--------------|
| DIMENSIONS ANSI Y14.5M UNITS: INCHES Pro/E FILE | TOLERANCES .XX ±0.01 .XXX ±0.005 ANGLES ±2.0° | PROJECTION | Amphenol Pcd SPECIFICATION DRAWING | | TITLE SJS, RECEPTACLE 3 POSITION SIZE 20 SHELL SIZE 7 | | |
| | | | ENGR TONY.CHEN | 10-Dec-13 | SIZE B | DWG NO. SJS862400_CE | REV 1 |
| ORIGINAL | THIS DOCUMENT CONTAINS PROPRIETARY INFORMATION WHICH IS THE CONFIDENTIAL PROPERTY OF AMPHENOL PCD INC., BEVERLY, MA | | CHKD | APPD | CODE: 58982 | SCALE: 3:1 | SHEET 1 OF 1 |