

| REV | ECN | APP'D |
|-----|------|------------|
| - | 2939 | JR 2/7/97 |
| A | 3043 | AP 7/22/97 |
| B | 3338 | |

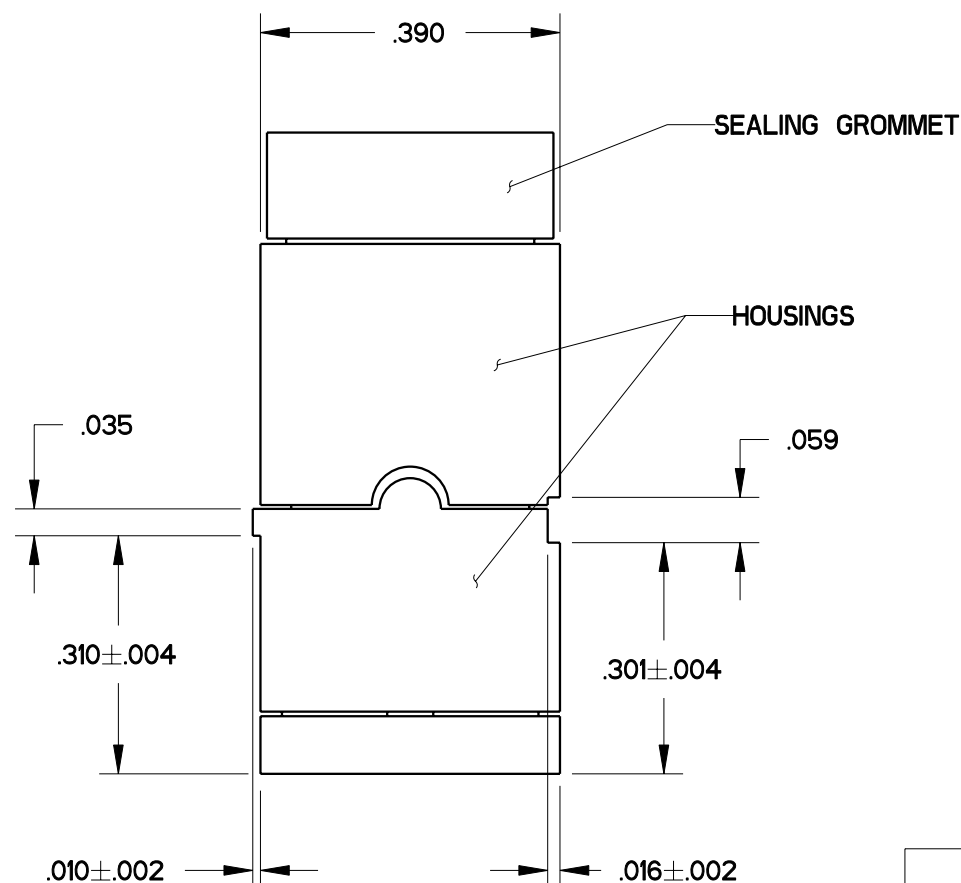
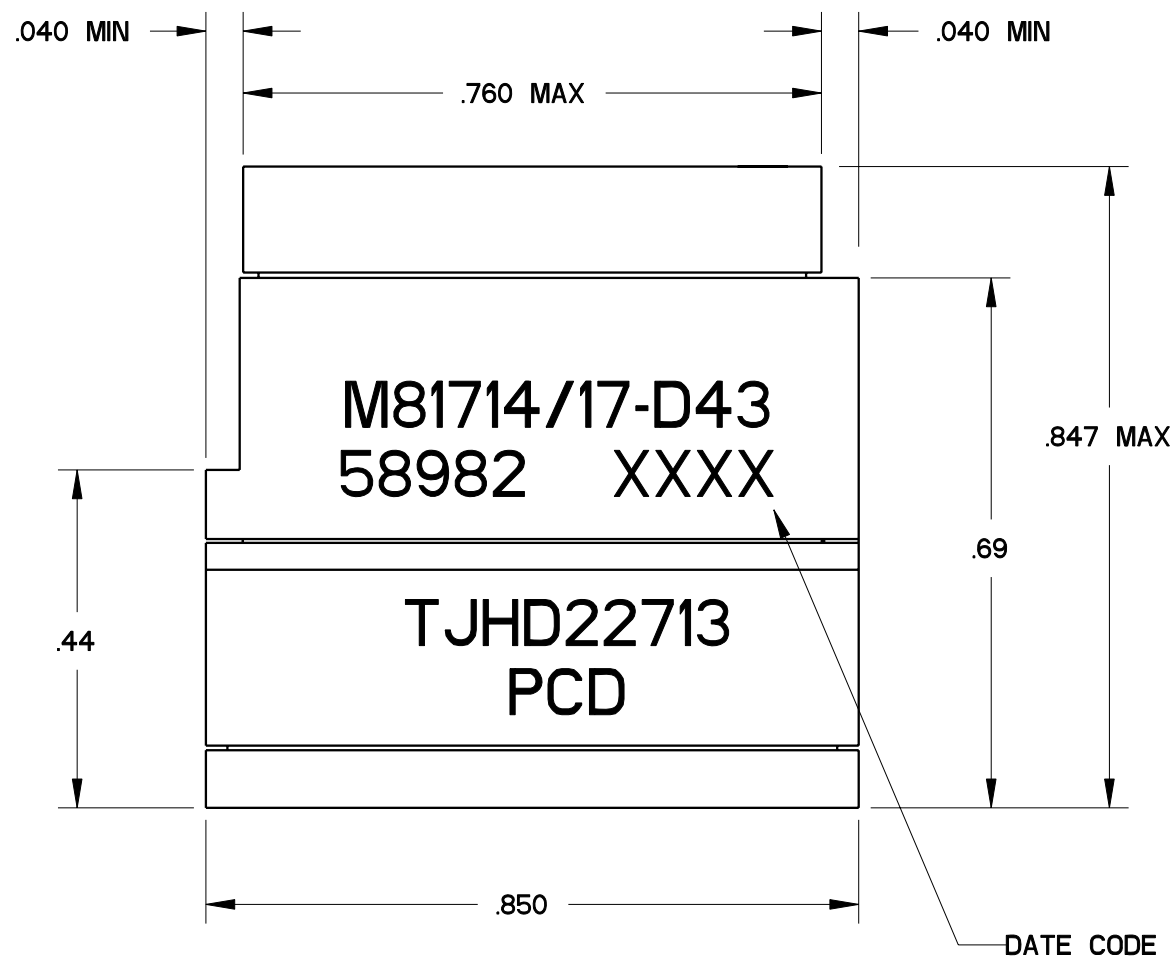
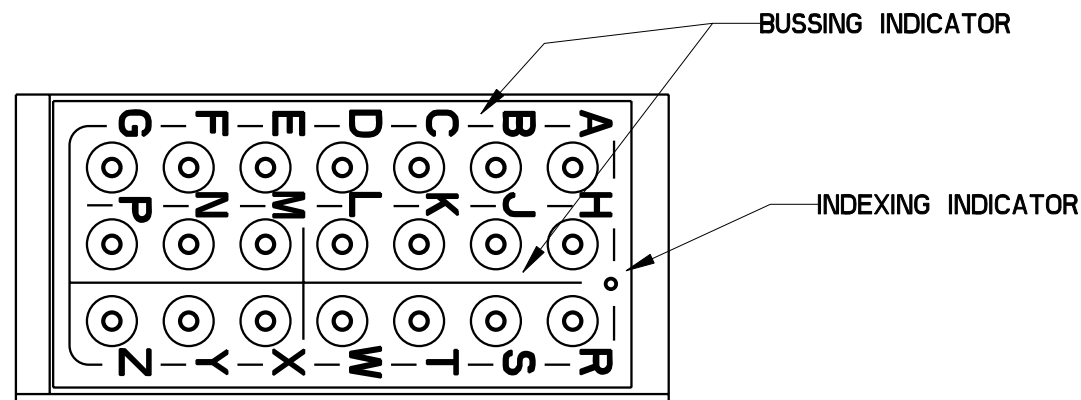

TJHD22613

TJHD22613

- NOTES:
 1. MATERIAL:
 HOUSINGS - THERMOPLASTIC, COLOR: BLACK.
 GROMMET - SILICONE RUBBER, COLOR: BLUE
 INTERNAL BUSSING, CONTACT RETAINERS - COPPER ALLOY
 2. MODULE ACCEPTS M39029/1-507 PIN CONTACTS

| DIMENSIONS | TOLERANCES | PROJECTION |
|---------------|---|------------|
| ANSI Y14.5M | .XX ±0.01 | |
| UNITS: INCHES | .XXX ±0.005 | |
| Pro/E FILE | ANGLES ±2.0° | |
| ORIGINAL | THIS DOCUMENT CONTAINS PROPRIETARY INFORMATION WHICH IS THE CONFIDENTIAL PROPERTY OF AMPHENOL PCD INC., PEABODY, MA | |

| | |
|-----------------------|----------|
| Amphenol Pcd | |
| SPECIFICATION DRAWING | |
| ENGR | |
| A. PATRIE | 03/09/06 |
| CHKD | |
| APPD | |

| PART NO. | INCLUDED W/ MODULE |
|-----------|--|
| TJHD22613 | MODULE ONLY |
| TJHD22713 | 22 EACH M39029/1-507 PIN CONTACTS 2 EACH MS27488-22 SEALING PLUGS |

| | | |
|---|------------------|----------|
| TITLE | | |
| MODULE, TERMINAL JUNCTION SIZE 22, HI-DENSITY D43 BUS ARRANGEMENT | | |
| SIZE | DWG NO. | REV |
| B | TJHD22613 | B |